

CAMPAIGN TEAM

Executive Committee:

Ben Stuckey, Tara Watts,
Cassy Zuver, Linda Staton

Communications:

Lindy Miller

Presentations:

Chad Olinger,
Michael Hoover

Spiritual Emphasis:

Laurie Sherck

Reminders:

Sally Schlatter

Arrangements:

Lori McGraw

Creative Gifts:

Steve Gage



WAYMAKER

CAMPAIGN BOOKLET



April 2018



CONTENTS

A Letter from the Pastor.....4-5

The History of our Church.....6-9

The Plan..... 10-11

The Design.....12-13

The Funding Plan.....16-17

Our Next Steps.....18-19



PASTORAL LETTER

Dear Church Family,

I am so grateful for your friendship and partnership in the gospel over the past two and a half years. God has blessed us immeasurably more than we could have asked or imagined in such a short time as we strive to *Build Relationships with Christ* in all we do. I truly believe our greatest days are just ahead.

When God called us here, I just knew in my spirit something big would happen. The Holy Spirit continued to encourage me to challenge this congregation to be “stewards of this county,” and “a light to LaGrange.” As you have continued to accept these challenges, we have continued to see countless lives transformed. Our fellowship has seen families restored, bondages broken, countless new families join us, people who once left the church return, numerous salvations, and baptisms. God has done a mighty work through you and He is ready to do another new work through you that seems almost impossible; a \$900,000 building expansion.

This project will enhance our mission and help our light shine even brighter in our community. However, any great work of God will require that His people make a renewed commitment to obey His will. Faithful obedience is not always easy, but it pleases the Lord when His people put their trust in Him. Kristen and I have been seeking God about our part in giving toward this project.

This booklet has been designed for you! It will help you get a closer look at all of the important aspects of the project, from the building design, to important dates, to the capital campaign process. I hope it will be very helpful to you and I pray it will challenge you as well.

One of the things that excites me the most about this project is that we have an opportunity to see what God will do when we come together to do His will. Imagine what will happen if every family prays and gives sacrificially toward this project! Imagine what God could do with a people who are obedient to His will and live out the Great Commission!

Number 6:24-26

Sincerely,
Pastor Ben Stuckey



CHURCH HISTORY

Throughout our church history, our people have been *WayMakers*, building relationships and chasing after God to do His ministry here in LaGrange, Indiana. It all started in the early 1920's when two families moved from Kentucky to Northern Indiana and began looking for a Church of God congregation. The John Lewis and Grover Asbury families found this community lacking such a congregation.

In May of 1921, land was acquired and with the help of the Emma Church of God, our first building was completed in October of 1921 at the corner of High and Lafayette Streets.

God blessed this ministry, and we purchased a home located next to the church in 1950. It was used for Sunday school classes and fellowship purposes.

By the early 1960s, our congregation was outgrowing our facilities! We were able to purchase five acres of land bordering State Road 9 and North Street in 1961. The parsonage on North Street was built in 1969.

Another era of growth was underway, and the children's church program was started in 1987. As we celebrated our 70th anniversary in 1991, the Family Life Center was completed.

In 2005, we added the Upper Room section to our existing building, a space that would continue to improve our ministry and help foster relationships. The Upper Room has since housed Youth and Children's ministries, bible studies, a counseling center, discipleship groups, baby and bridal showers, and small worship gatherings.

March 2012 brought the most recent renovations to our church. Seeing the need for a fellowship area, the original kitchen and library were repurposed to create the cozy cafe we all enjoy every Sunday.

In 2016, the congregation welcomed a new lead pastor, Ben Stuckey, and it is with his leadership that we are now, in 2018, asking God to *make a way*, with us as *WayMakers*, to grow the ministry of LaGrange First Church of God through this building campaign.

A CHURCH WITH A 97 YEAR HISTORY



1950: Adjacent property (house)

1969: Current parsonage purchased



" I remember all the picnics at Delt Church Park. Many of us rode our bikes from the church to the park. Once at the park, there were egg tosses and balloon fights, but my favorite part was Bev and Stan Combs giving us all pony cart rides. I also remember Ann Thomason leading singing with her hammer dulcimer. "

- Brad Fry

OF BUILDING RELATIONSHIPS

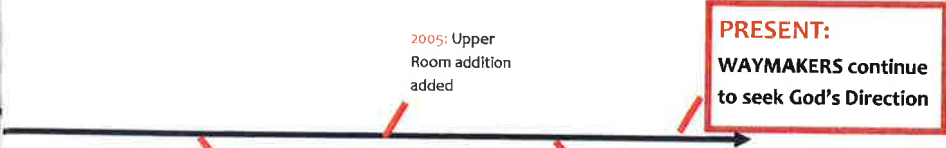

1999: FLC addition complete

2012: Café renovation made

" As I think back to my younger years at First Church of God, I smile as I think about my grandparents, Oscar and Mary Christner. I would sit beside grandma and lay my head on her lap during church...After church I would rush to stand beside Pastor Beaver. He would just take my hand and continue to greet those leaving the church."

-Cindy Hoover



Our WayMaker Pastors

1921-1922:
Samuel A. Bathour

1922-1927:
Walter Schrock

1927-1930:
Charles Smith

1930-1968:
Laurence Beaver

1969-1976:
Roberts Fields

1976-1977:
Edward Duty

1977-1985:
Ronald Drake

1985-1997:
Eugene Fauntleroy

1995-2014:
Brian VanOsdol

2014-2016 :
Harold Ferraro

2016-Present:
Benjamin Stuckey

THE PLAN

Our updated sanctuary:

“Come and dine with us – there’s always room at our table!” Isn’t that what we all love to hear when we are invited to dinner? That’s the atmosphere we hope to generate as we create more seating in our sanctuary. Here in our church home, we want to provide room for our own “family” as well as extra places for our friends and guests. In the updated sanctuary, there will be ample seating for all to sit together and worship fully – no more sitting on the “sidelines” along the wall. With extra seating, we will encourage the community to join us for there is room at our table. What a great way to say, ‘come, taste and see that

Our new nursery and children’s ministry:

Safety for our children is a subject much talked about in our culture. Parents are reassured when we offer a safe environment for their children to learn and worship. Only then can they themselves feel comfortable worshipping in the sanctuary. By creating a controlled access point for security, we are taking the necessary steps to provide that safety. We are also improving our nursery area, where new mothers will be able to partake of the worship service even as they care for their infant in our new mother’s room. And if babies need to rest, they will be able to nap as our new nursery will provide a divided space that allows babies to sleep while other toddlers play. Visitors, especially, will appreciate the new location of this children’s wing as it is easily seen and accessible from the new common space.

Worship area

- ◆ Create more seats in the Sanctuary
- ◆ Improve sound system
- ◆ Update finishes

Circulation and commons areas

- ◆ Create larger commons area and relocate cafe
- ◆ Update restrooms and make them ADA compliant
- ◆ Repurpose current smaller cafe space

Children’s area

- ◆ Create a controlled access point for security and ease of check in/ out process
- ◆ Make Nursery improvements
- ◆ Begin the process for future plans to complete a children’s wing

Overall finish upgrades

- ◆ Update current foyer finishes to match renovated areas and improve flow
- ◆ Update finishes, repair walls, and improve acoustics in the Family Life Center
- ◆ Update lower level restrooms in the Family Life Center

Office spaces

- ◆ Provide safety and controlled access during the week
- ◆ Add sound-proofing between offices for counseling purposes
- ◆ Consolidate staff to a central office location

Parking/Site

- ◆ Create a better flow of the parking lot
- ◆ Create more parking spaces to accommodate the increase space in the sanctuary, starting with 24 spaces using limestone base, preparing for additional parking in the future.
- ◆ Create easily identifiable entrance to our church facility
- ◆ Reshape the storm-water retention for future development

Our remodeled lobby and cafe:

Our current cafe has exceeded our expectations over the last several years by providing an intimate atmosphere for people to gather. Whether it’s a few women sitting around a table on Sunday morning, or an evening small group meeting, this beautiful common space has encouraged and nurtured relationships. To help cultivate this trend, we will enlarge our cafe by adding more tables and chairs to provide more cozy meeting places. And if coffee “dates” are your thing, you’ll find our new cafe the perfect spot to meet one on one. The larger common space will allow for a much better traffic flow when large groups are in the church such as Sunday mornings, weddings and funerals. It will also be the ideal place to host a bridal or baby shower. Another benefit of a larger common space is the easy access it will allow to our new expanded children’s wing. Members and visitors alike will feel the warm welcome when they step into this new and improved space.

THE DESIGN

Office space renovation

New sanctuary renovation

New Commons area and Cafe

New Children's Ministry Check in and Nursery

PHASE 1

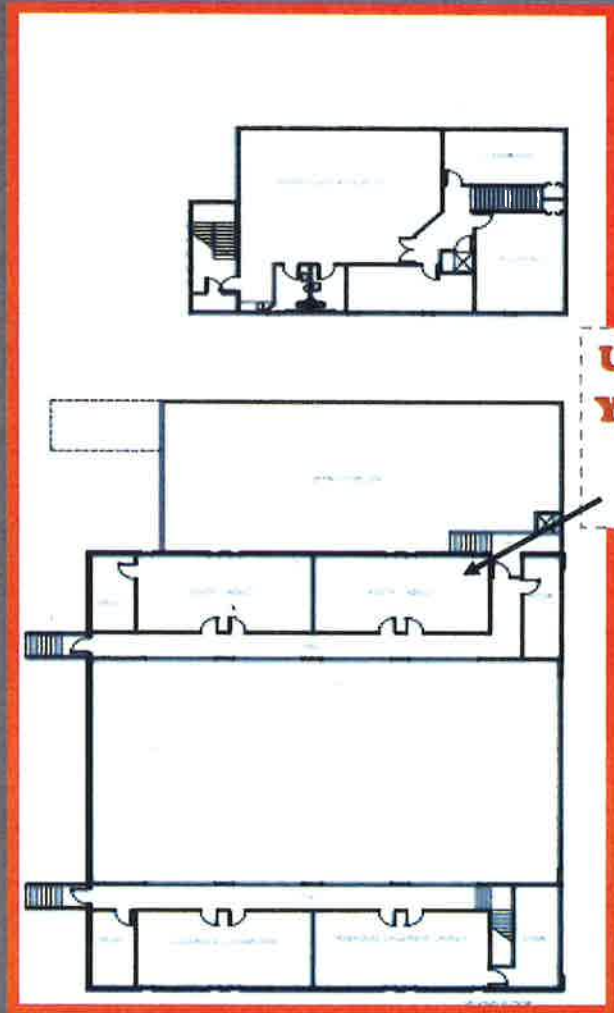
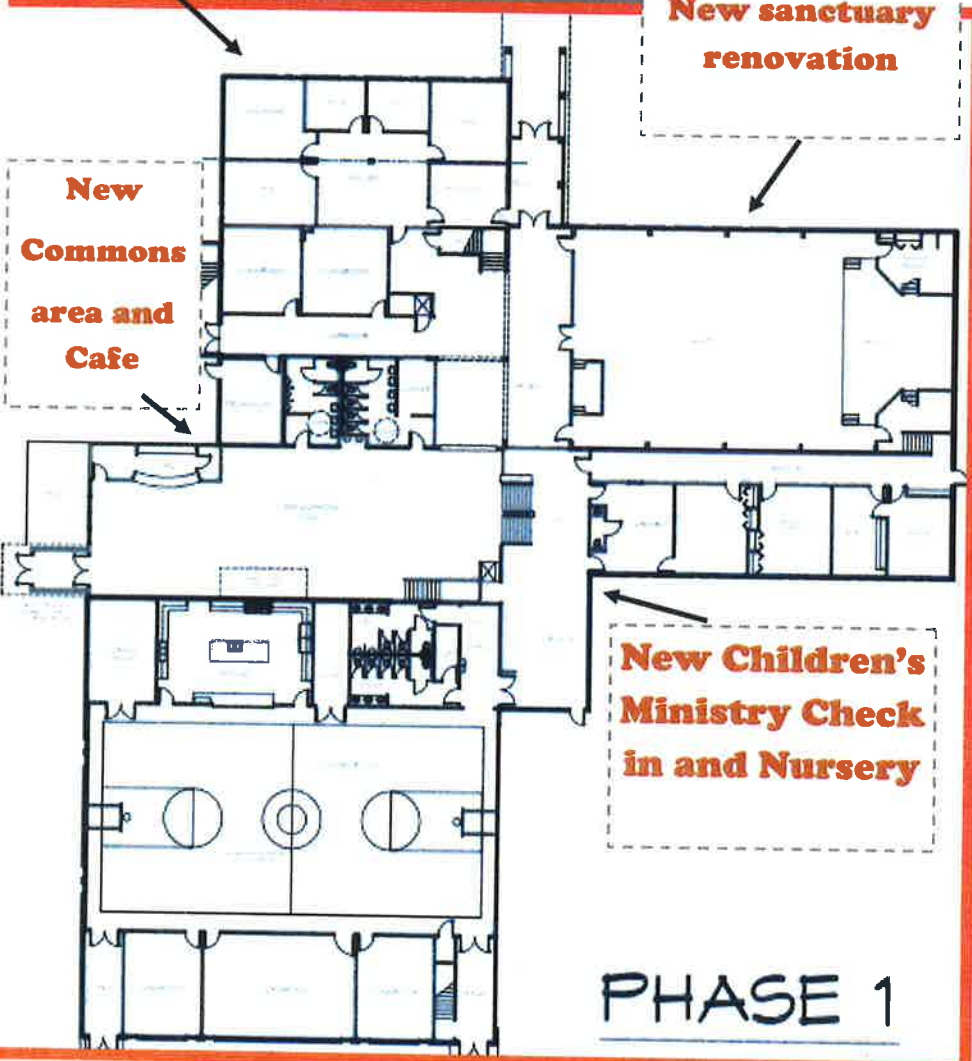

Upper level Youth classrooms

Upper levels

"My favorite memory is being able to be in the baptismal pool to baptize all four of my kids." -Elisa Schackow

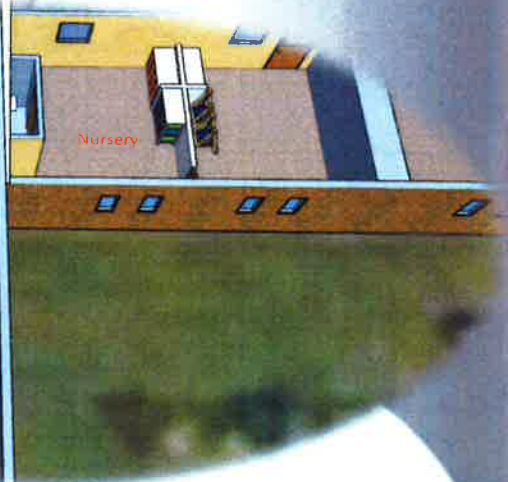

"I love all the Bible Schools we've had over the years that I've attended and how many children we bring to the church because of them." -Erin Olinger



"With the remodel, I'm looking most forward to getting rid of the orange Carpet."

-Greg Weldon

"One of my favorite church memories is when we took the youth kids to stay all night at the zoo."

-Amy Miller



"I'm looking forward to more seating and for more airflow in the Sanctuary because it tends to get warm in there." -Natalie Glick

LAGRANGE CHURCH OF GOD

CHART OF GIFTS - Helping to Define Your Sacrifice
3-Year Goal - \$900,000

As you consider your gift to this stewardship campaign, please consider these questions:

- A. Have I surrendered everything to God including my job, family, treasures, etc.?
- B. Will I asked God what His sacrificial campaign gift is for me?
- C. Will I obey what He reveals to me?
- D. Does my heart respond with joy to my giving sacrificially at this level?

# INDIVIDUAL HOUSEHOLDS	Individual Households				COLLECTIVE 3-YEAR	
	3-YEAR AMOUNT	WEEKLY AMOUNT	MONTHLY AMOUNT	ANNUAL AMOUNT		
1	\$125,000	\$801	\$3,472	\$41,667	\$125,000	D
1	\$100,000	\$641	\$2,778	\$33,333	\$100,000	E
2	\$50,000	\$321	\$1,389	\$16,667	\$100,000	E
3	\$25,000	\$160	\$694	\$8,333	\$75,000	P
7	\$15,000	\$96	\$417	\$5,000	\$105,000	
10	\$10,000	\$64	\$278	\$3,333	\$100,000	
12	\$7,500	\$48	\$208	\$2,500	\$90,000	W
20	\$5,000	\$32	\$139	\$1,667	\$100,000	I
32	\$2,500	\$16	\$69	\$833	\$80,000	D
25	\$1,000	\$6	\$28	\$333	\$25,000	E
113					\$900,000	

PLEASE NOTE OUR CAPITAL CAMPAIGN WILL SUCCEED WITH EQUAL SACRIFICE, NOT EQUAL GIFTS.

Each "3-Year Amount" corresponds with the number of individual commitments we will need from households at our church to make our goal.

THE FUNDING PLAN

Our funding plan consists of two primary components: Proceeds from our three year capital campaign, and our current cash on hand. We believe with the money provided from these resources we will need around \$900,000 to complete phase one of this project. We hope through this campaign that we will have enough vested WayMakers to be able to reach our goal without having to obtain any or very little additional debt.

We have been challenged to be WayMakers; to be **Bold, Careless, Obedient, Called, Faithful, Prayerful**, and now **Active**. We ask that you will pray about your commitment and be active in this NEW THING, God is doing in our Church.

"With the remodel, I'm looking forward to more people being able to come to church." -Jerry Hicks Jr.



Our Next Steps

PRAY...

That God would guide you in your decision to make a commitment representing personal sacrifice.

DISCUSS...

Your commitment with your spouse and/or other members of your family.

COMMIT...

Complete the Commitment Card and place it in the envelope provided.

RESPOND BY...

For those attending the Advance Challenge Meeting: Return your sealed envelope personally to Tara Watts or the church office by April 22, 2018.

For the congregation: Return your sealed envelope on Commitment Sunday, May 6, 2018.

